

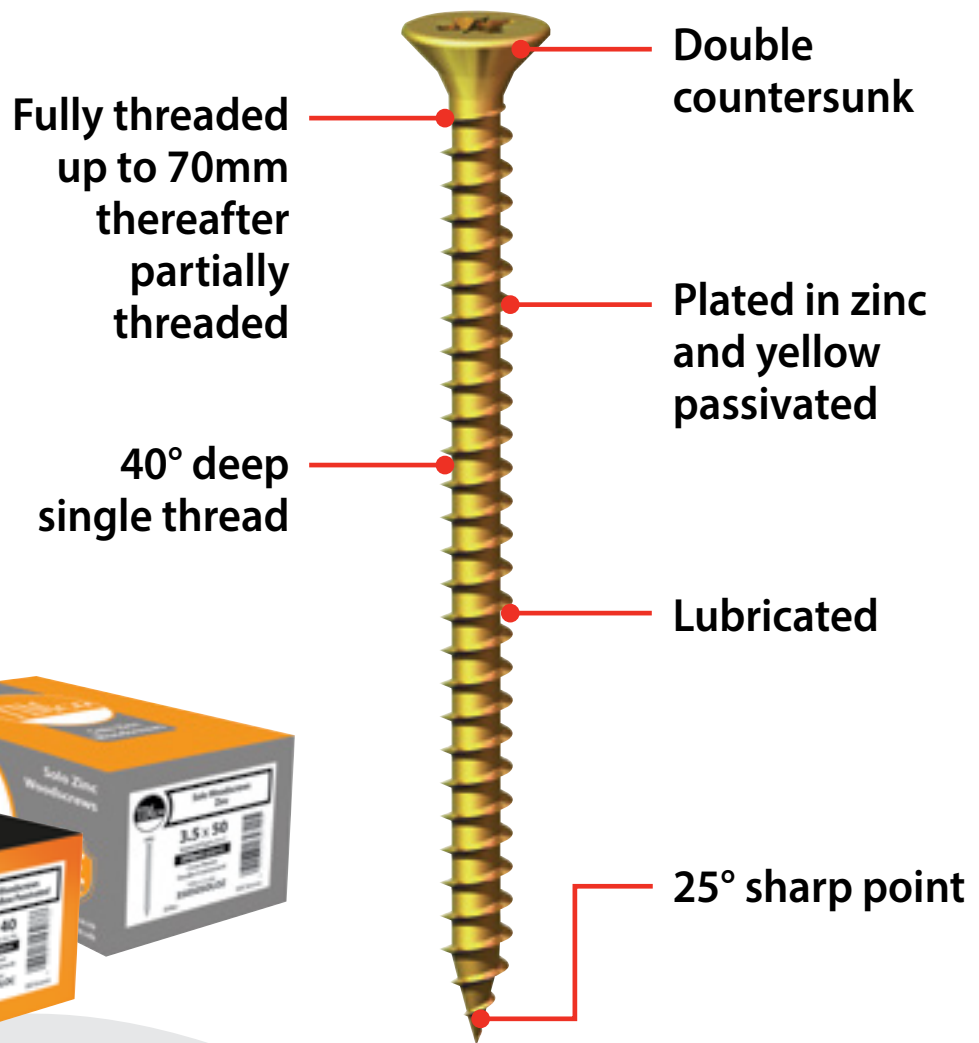

CE Declaration of Performance

Solo

Woodscrews



Certain Hardwood



Softwood



PVC u



Chipboard

Dimensional & Performance Declaration

Solo Yellow Cross-Recess Double Countersunk

Size	Nominal diameter d (mm)	Inner thread diameter d1	Total Length L (mm)	Thread Length lg (mm)	Head diameter dh (mm)	Test Report No.	Certificate No.	Characteristic yield moment $M_{y,k}$ (Nmm)	Characteristic withdrawal parameter $f_{3x,k}$ (N/mm ²)		Characteristic head pull-through parameter $f_{head,k}$ (N/mm ²)			Characteristic tensile capacity $f_{tens,k}$ (kN)	Characteristic torsional ratio													
									Loading across the fibre	Loading along the fibre	Csk	Hinge	Pan															
3.0 x 12	3.0	2.00	12	8.85	6	No. 30-9797/7	E-30-20008-13	1 051	17,99	12,37	45,41	3,11	6,28	3,11	6,28													
3.0 x 15			15	11.85																								
3.0 x 17			17	13.85																								
3.0 x 20			20	16.85																								
3.0 x 25			25	21.85																								
3.0 x 30			30	26.85																								
3.5 x 12	3.5	2.25	12	8.18	7	No. 30-9797/8	E-30-20009-13	2 873	18,55	11,04	35,55	4,57	2,90	4,57	2,90													
3.5 x 15			15	11.18																								
3.5 x 17			17	12.18																								
3.5 x 20			20	16.18																								
3.5 x 25			25	21.18																								
3.5 x 30			30	26.18																								
3.5 x 35			35	31.18																								
3.5 x 40			40	36.18																								
3.5 x 50			50	46.18																								
4.0 x 15			4.0	2.50												15	10.83	8	No. 30-9797/9	E-30-20010-13	4 186	17,85	11,52	28,02	-	33,61	5,99	3,45
4.0 x 17	17	12.83																										
4.0 x 20	20	15.83																										
4.0 x 25	25	20.8																										
4.0 x 30	30	25.8																										
4.0 x 35	35	32.8																										
4.0 x 40	40	35.8																										
4.0 x 45	45	40.8																										
4.0 x 50	50	45.8																										
4.0 x 55	55	50.8																										
4.0 x 60	60	55.8																										
4.5 x 20	4.0	2.50	20	15.26	9	No. 30-9797/10	E-30-20011-13	5 171	19,42	13,22	27,02	-	-	6,75	3,36													
4.5 x 30			30	25.26																								
4.5 x 35			35	30.26																								
4.5 x 40			40	35.26																								
4.5 x 45			45	40.26																								
4.5 x 50			50	45.26																								
4.5 x 60			60	55.26																								
4.5 x 70			70	65.26																								
4.5 x 80			80	70																								
5.0 x 25			5.0	3.10												25	19.6	10	No. 30-9797/11	E-30-20012-13	7 157	18,29	10,12	24,90	-	-	9,74	3,86
5.0 x 30	30	24.6																										
5.0 x 35	35	29.6																										
5.0 x 40	40	34.6																										
5.0 x 45	45	39.6																										
5.0 x 50	50	44.6																										
5.0 x 60	60	54.6																										
5.0 x 70	70	64.6																										
5.0 x 75	75	70																										
5.0 x 80	80	70																										
5.0 x 90	90	70																										
5.0 x 100	100	70																										
6.0 x 40	6.0	3.80			40	33.9	12	No. 30-9797/12	E-30-20013-13	11 810	16,94	10,18	27,70	-	-	11,88	2,94											
6.0 x 50					50	43.9																						
6.0 x 60			60	53.9																								
6.0 x 70			70	63.9																								
6.0 x 80			80	70																								
6.0 x 90			90	70																								
6.0 x 100			100	70																								
6.0 x 120			120	70																								
6.0 x 130			130	70																								
6.0 x 150			150	70																								

Durability: Service Class 1 acc. To EN1995-1-1)

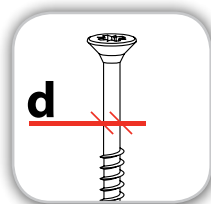

Nominal Diameter

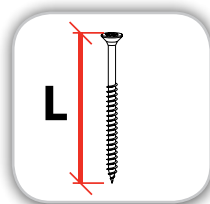

Total Length

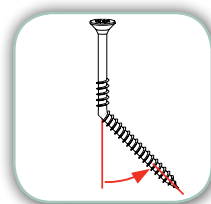

Yield Movement

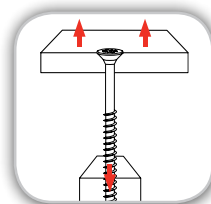

Withdrawal Parameter

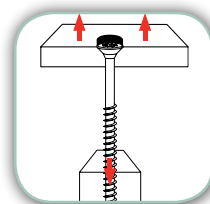

Head Pull-through

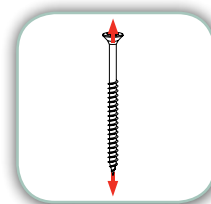

Torsional Ratio

Dimensional & Performance Declaration

Solo Zinc Cross-Recess Double Countersunk

Size	Nominal diameter d (mm)	Inner thread diameter d1	Total Length L (mm)	Thread Length lg (mm)	Head diameter dh (mm)	Test Report No.	Certificate No.	Characteristic yield moment $M_{y,k}$ (Nmm)	Characteristic withdrawal parameter $f_{ax,k}$ (N/mm ²)		Characteristic head pull-through parameter $f_{head,k}$ (N/mm ²)			Characteristic tensile capacity $f_{tens,k}$ (kN)	Characteristic torsional ratio
									Loading across the fibre	Loading along the fiber	Csk	Hinge	Pan		
3.0 x 12 3.0 x 15	3.0	2.00	12	8.85	6	No. 30-9797/7	E-30-20008-13	1 051	17,99	12,37	45,41	56,88	-	3,11	6,28
15			11.85												
3.5 x 15 3.5 x 20 3.5 x 25 3.5 x 30 3.5 x 35 3.5 x 40 3.5 x 50	3.5	2.25	15	11.18	7	No. 30-9797/8	E-30-20009-13	2 873	18,55	11,04	35,55	-	45,75	4,57	2,90
20			16.18												
25			21.18												
30			26.18												
35			31.18												
40			36.18												
50			46.18												
4.0 x 15 4.0 x 17 4.0 x 20 4.0 x 25 4.0 x 30 4.0 x 35 4.0 x 40 4.0 x 45 4.0 x 50 4.0 x 60 4.0 x 70	4.0	2.50	15	10.83	8	No. 30-9797/9	E-30-20010-13	4 186	17,85	11,52	28,02	-	33,61	5,99	3,45
17			12.83												
20			15.83												
25			20.83												
30			25.83												
35			30.83												
40			35.83												
45			40.83												
50			45.83												
60			55.83												
70			65.83												
4.5 x 40 4.5 x 45 4.5 x 50 4.5 x 60 4.5 x 70			4.5	2.70											
45	40.26														
50	45.26														
60	55.26														
70	65.26														
5.0 x 25 5.0 x 30 5.0 x 40 5.0 x 45 5.0 x 50 5.0 x 60 5.0 x 70 5.0 x 80 5.0 x 90 5.0 x 100	5.0	3.10	25	19.6	10	No. 30-9797/11	E-30-20012-13	7 157	18,29	10,12	24,90	-	-	9,74	3,86
30			24.6												
40			34.6												
45			39.6												
50			44.6												
60			54.6												
70			64.6												
80			70												
90			70												
100			70												
6.0 x 50 6.0 x 60 6.0 x 80 6.0 x 90 6.0 x 100 6.0 x 120 6.0 x 150	6.0	3.80	50	43.9	12	No. 30-9797/12	E-30-20013-13	11 810	16,94	10,18	27,70	-	-	11,88	2,94
60			53.9												
80			70												
90			70												
100			70												
120			70												
150			70												

Durability: Service Class 1 acc. To EN1995-1-1)

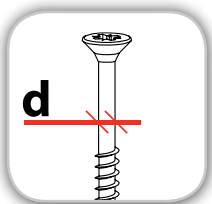

Nominal Diameter

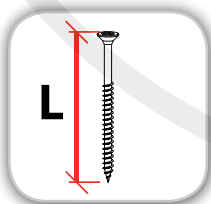

Total Length

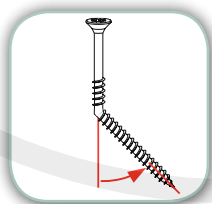

Yield Movement

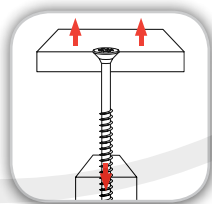

Withdrawal Parameter

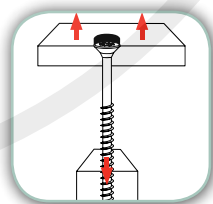

Head Pull-through

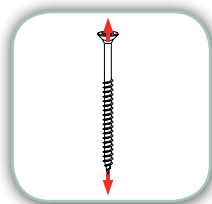

Torsional Ratio

TIMco SOLO Woodscrews



DECLARATION OF PERFORMANCE

DOP2 v1

We here by declare the following designated products

TIMco SOLO Woodscrews
Diameter 3.0mm, 3.5mm, 4.0mm, 4.5mm, 5.0mm, 6.0mm.

Have been tested by the following independant testing organisation:

- Notified Body 1015
Strojirensky Zkusebni Ustav, s.p., Czech Republic

And that they have performed initial type testing under system 3, Annex V of the regulation (EU) no. 305/2011 (Construction Products Regulation), with the reference to the harmonised European standard (hEN) BS EN 14592:2008+A1:2012 (Timber structures - Dowel type fasteners - Requirements) for nails intended for the use in "load bearing timber structures" and produced the calculation/test reports as listed below;

Certificate Number: E-30-20007-13 to E-30-20013-13

Test Report Number: No. 30-9797/1 to No. 30-9797/12.

Factory Process Control (FPC) has been established by the factory and independently audited by TUV Rheinland UK in accordance with ISO9001:2008..

This declaration of conformity is valid until there is a significant change in the product and declared characteristics. ie. raw material or change in production process.

Signed by:

Name: *Simon Midwood*

Position: *Managing Director*

Date: *23.04.2013*

This declaration is the responsibility of the importer

T.I Midwood & Co. Ltd. Green Lane, Wardle, Nantwich, Cheshire, CW5 6BJ

