

BS5301

Heavy Duty Ball Bearing Slide 重型滑轨

- Applications: Storage cabinets, kitchen
- Cabinets and office cabinets, etc.
- Features: Conveniently to install, could do heavy load.
- Load capacity: 175 lbs(80kgs)/450mm per pair
- Finish: Zinc plated or Black
- Lengths: 250mm-900mm
- Thickness: 2.0x2.0x2.0

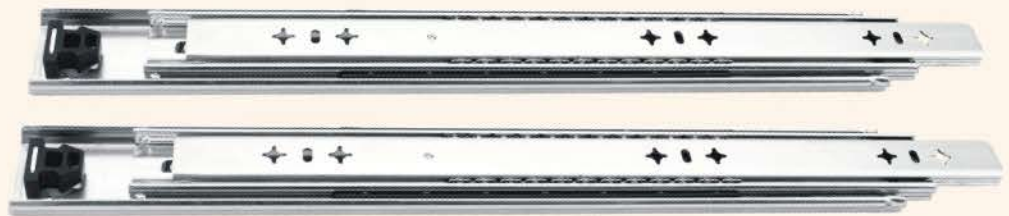
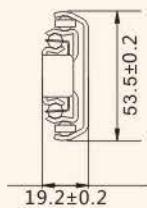
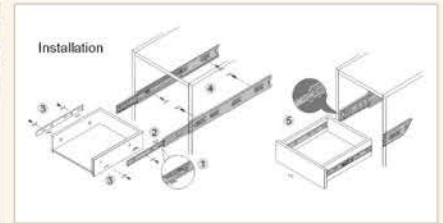
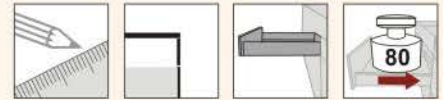

Product Drawings

产品图纸

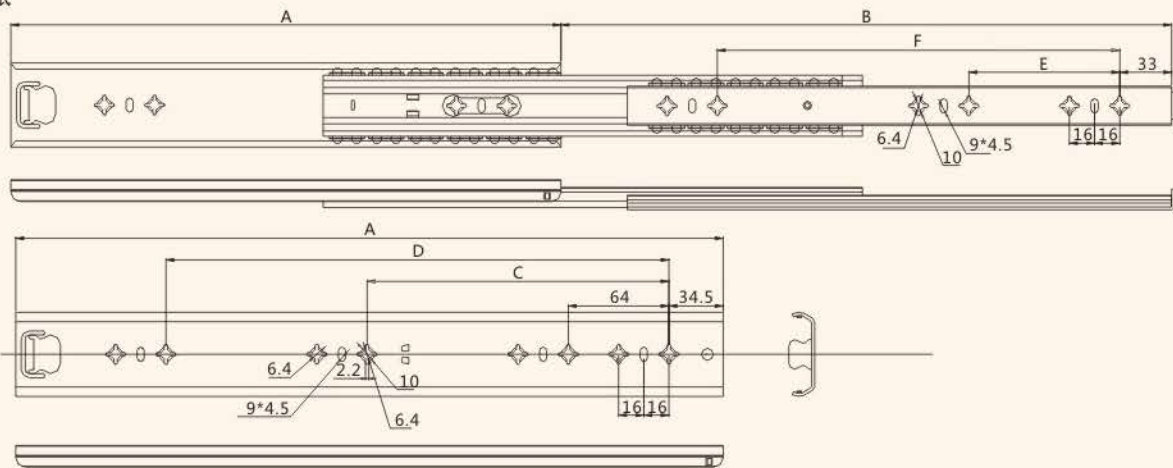

订货号 Item No.	A(mm)	B(mm)	C(mm)	D(mm)	E(mm)	F(mm)	包装(套/箱) Packing(set/ctn)
BS5301-350	350	356	224	--	96	256	10
BS5301-400	400	406	160	256	128	288	10
BS5301-450	450	457	192	352	160	352	10
BS5301-500	500	508	224	352	192	384	10
BS5301-550	550	559	224	352	224	448	10
BS5301-600	600	610	224	352	224	480	10