

GATEMATE DOUBLE STRAP HINGE SET

CODE PREFIXES: 030300,
030450 & 030600

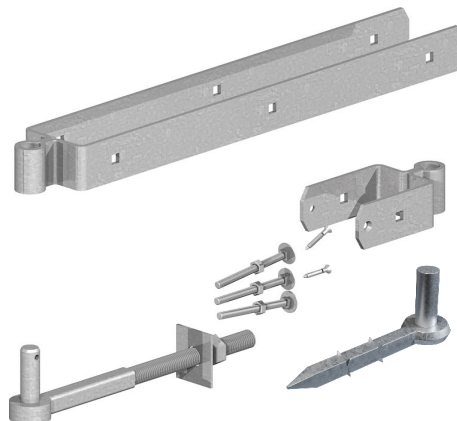

DESCRIPTION

These double strap hinge sets are designed for hanging wooden field gates and driveway / pedestrian entrance gates. They give excellent support to the gate frame as the bands sit on both sides of the gate and are bolted through the gate stile and screwed through the top rail. The hook to bolt (top) has a drilled pin so that a split pin or bolt can be inserted to prevent the removal of the gate. The hook to drive (bottom) has barbs to prevent the shaft moving in the post during gate operation. All fixings are supplied with the sets and have matching finishes to further enhance the sets. These sets are designed for 75mm thick (3") gates. For gates that require 50mm bands see website.

CONSTRUCTION

GALVANISED: The Galvanising is coated in accordance with BS EN ISO 1461:2009. The average coating thickness is 45 microns. If the galvanised product is fitted correctly and the surface finish is not damaged the service life of 10 years can be expected.

PREMIUM BLACK: is a durable superior finish coated on steel products (Polyester coating on hot dipped galvanise). The Galvanising is coated in accordance with BS EN ISO 1461:2009. The average coating thickness is 45 microns. The product is manufactured from mild steel and is hot dip Galvanised to ensure maximum corrosion resistance.

After galvanising, the product is degreased and rinsed in deionised water, phosphated to provide excellent coating adhesion. The product is then powder coated within 3 hours of phosphating.

If the product is fitted correctly and the surface finish is not damaged the service life of 10 years can be expected.

BLACK POLYESTER COATING: Polyester powder coating is a type of coating that is applied as a free-flowing dry powder. The powder is a thermoset polymer, which is used to create a hard finish that is tougher than conventional paint. Powder coating is mainly used for the coating and protection of metals.

Polyester Powder Coatings offer durable decorative finishes in a wide range of colours, textures, and gloss levels. They are formulated to provide maximum corrosion resistance, colour stability and gloss retention. They are suitable for interior and exterior use and entirely T.G.I.C free (triglycidyl isocyanate crosslinkers).

All items are coated in accordance with BS-13438.

The service life for Premium Black coating is 15 years.

FINISH

Galvanised	Epoxy Black	Premium Black



HINGE LOADING APPLICATION PER PAIR

When selecting hinges for your gate please ensure that you choose ones with the correct loading application.

This is only approximate hinge loading application as none of our hinges are tested.

For heavier gates an additional hinge can be added.

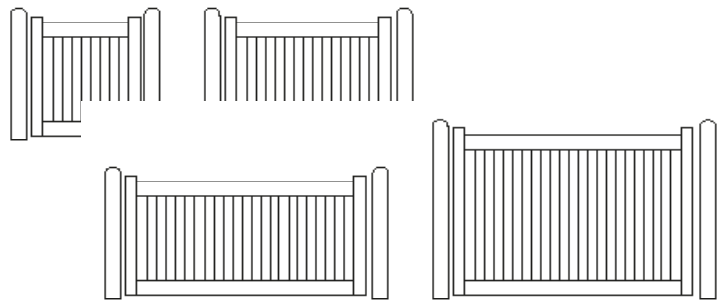

GATE TYPE	CLASS	WEIGHT	MAXIMUM WIDTH
A	SMALL GATES AND DOORS	UP TO 10KG	900MM
B	MEDIUM GATE	UP TO 20KG	1200MM
C	LARGE GATE	UP TO 50KG	1800MM
D	EXTRA LARGE GATE	UP TO 80KG	2400MM

DOUBLE STRAP HINGE SETS

- Heaviest field gate sets on the market!
- Hot dip galvanised fixings included

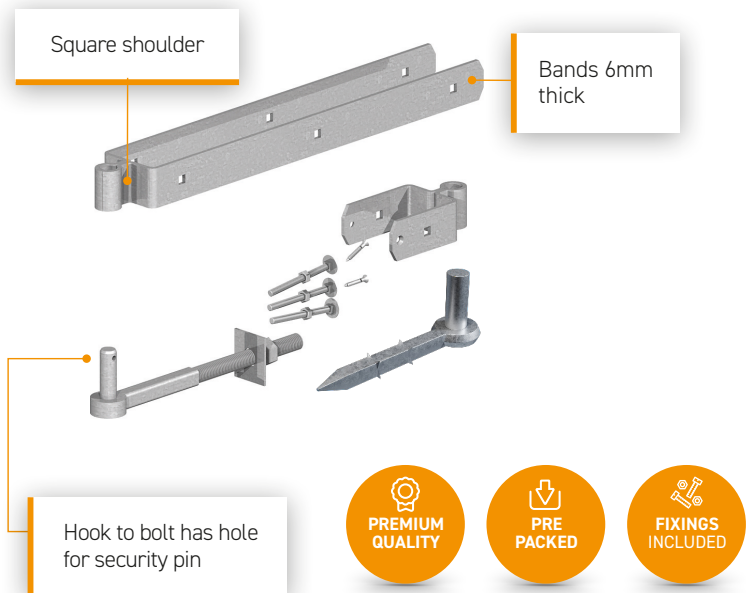

GATEMATE® Field Gate Double Strap Hinge Set

FINISH	SIZE INS (MM)	TOP BAND (MM)	BOTTOM BAND (MM)	PIN DIA (MM)	SUITABLE FOR	HOOK TO BOLT SIZE (INS)	LOAD APPL.	MIN. ORDER QTY	OUTER CARTON QTY	PALLET QTY	CODE
Galvanised	12 (300)	300x50x6	125x50x6	19 (3/4)	3" gates	13"	D	1	4	120	030 3001
Galvanised	18 (450)	450x50x6	125x50x6	19 (3/4)	3" gates	13"	D	1	4	120	030 4501
Galvanised	24 (600)	600x50x6	125x50x6	19 (3/4)	3" gates	13"	D	1	4	120	030 6001
Epoxy Black	24 (600)	600x50x6	125x50x6	19 (3/4)	3" gates	13"	D	1	4	120	030 6003
Premium Black	24 (600)	600x50x6	125x50x6	19 (3/4)	3" gates	13"	D	1	4	-	030 600B

Includes: 2" x 1/4" top band, 5" x 2" x 1/4" bottom band, hook to bolt, hook to drive and fixings